

www.rera.rajasthan.gov.in
RERA Registration Number
RAJ/P/2023/2652



THE CENTURY GARDEN

1&2 BHK Premium Apartment
@ Mansarovar Ext., Jaipur

Let life flow through...



THE NEW
DEFINITION OF
OPULENCE
GREEN



CRAFTED
LUXURY BEYOND
BOUNDARIES

348
1/2 BHK
APARTMENTS

SPACIOUS
GREEN AREA

INDOOR
GAMES





PRIME LOCATION

AND EVERYTHING
WITHIN REACH

Century Garden stands as an emblem of sophistication and exclusivity. With its prime location, residents will find themselves at the epicenter of urban convenience and prestige, with renowned dining, cultural attractions, and high-end boutiques just steps away. This enviable setting not only offers breathtaking views of the city skyline but also provides a seamless blend of cosmopolitan living and tranquility.





YOUR VERY
OWN PIECE
OF HAVEN

Welcome to your very own haven of opulence and serenity. Each residence is a masterpiece of architectural excellence, boasting spacious interiors bathed in natural light and complemented by awe-inspiring views of the surrounding beauty. Our commitment to luxury is evident in every detail, from the world-class amenities that cater to your every need to the meticulously landscaped grounds that offer a peaceful retreat.





EXTRAORDINARY
DESIGNS &
DETAILING

In the heart of our exclusive Century Garden complex lies a world where design transcends the ordinary and detailing becomes an art form. With an unwavering commitment to sophistication, every corner is adorned with bespoke finishes, from the opulent marble flooring to the intricately designed lighting fixtures. The seamless blend of natural light, open spaces, and carefully chosen materials creates an ambiance that exudes elegance.





LUXURIOUS SPACES &

EXTRAVAGANT LIFESTYLE

Indulge in a lifestyle of unparalleled refinement and grandeur at our Century Garden. Here, opulent living spaces seamlessly merge with the breathtaking natural surroundings, offering an oasis of tranquility and sophistication. Each residence is a testament to architectural excellence, featuring sumptuously appointed interiors, panoramic vistas, and an array of amenities that cater to your every desire.



OPULENT LIVING



PLAYFUL OASIS

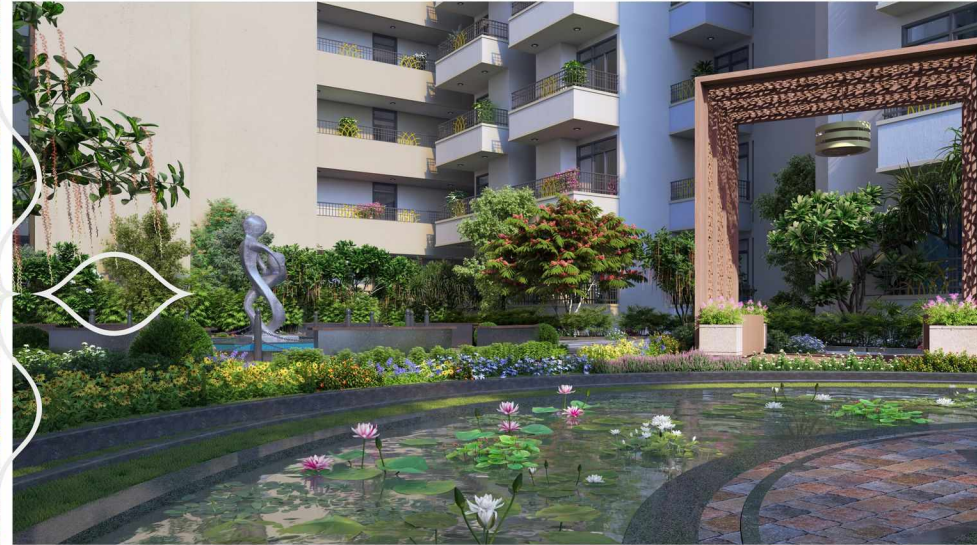

SERENE MOMENTS & PLAYFUL DATES

Here, your family will discover a haven of green serenity and vibrant blossoms, inviting cherished moments amidst the captivating beauty of our outdoor oasis. Our thoughtfully curated children's play area within this verdant paradise ensures that young imaginations are set free, offering a secure space for boundless joy and adventure. It's a harmonious blend of nature and nurture, where families can flourish and children can thrive.





GREEN
SERENITY



CAPTIVATING SPACES TO
BOND AND SOCIALIZE





AQUATIC
RETREAT

SWIMMING POOL

THE CENTURY
GARDEN

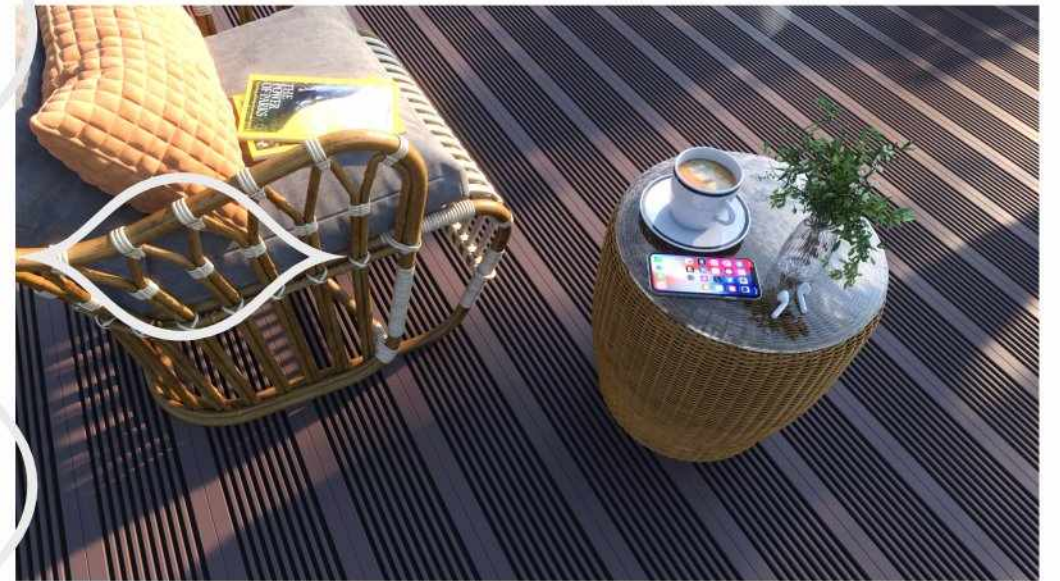

LUXURY,
COMFORT &
UNPARALLELED
SPLENDOR

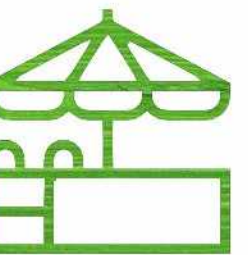

MASTER PLAN



EMBRACE EACH MOMENT AMIDST LUSH GREENS

At this magnificent residential apartment with a podium garden that redefines urban life, you may experience the serenity of nature's embrace. Wander the green jogging path, discover peace by the tranquil lily pond, or engage in leisurely chats in the gazebo area. Our meticulously designed senior citizen section is a refuge of leisure, while the large landscape garden is an oasis of greenery amidst the rush and bustle of the city. The amphitheater becomes your personal platform for making unforgettable experiences. Discover a balanced combination of modern conveniences and natural beauty that invites you to savor every minute. Where tranquility meets refinement, your ideal lifestyle awaits.

FIRST FLOOR PLAN



TYPICAL FLOOR PLAN





TYPE 02

2 BHK
UNIT

Carpet Area
612.57 Sq. Ft.

Built-up Area
715.16 Sq. Ft.

Balcony Area
59.84 Sq. Ft.

Saleable Area
900.00 Sq. Ft.



TYPE
03

2 BHK
UNIT

Carpet Area
623.88 Sq. Ft.

Built-up Area
731.73 Sq. Ft.

Balcony Area
64.26 Sq. Ft.

Saleable Area
920.00 Sq. Ft.





MODERN GYM

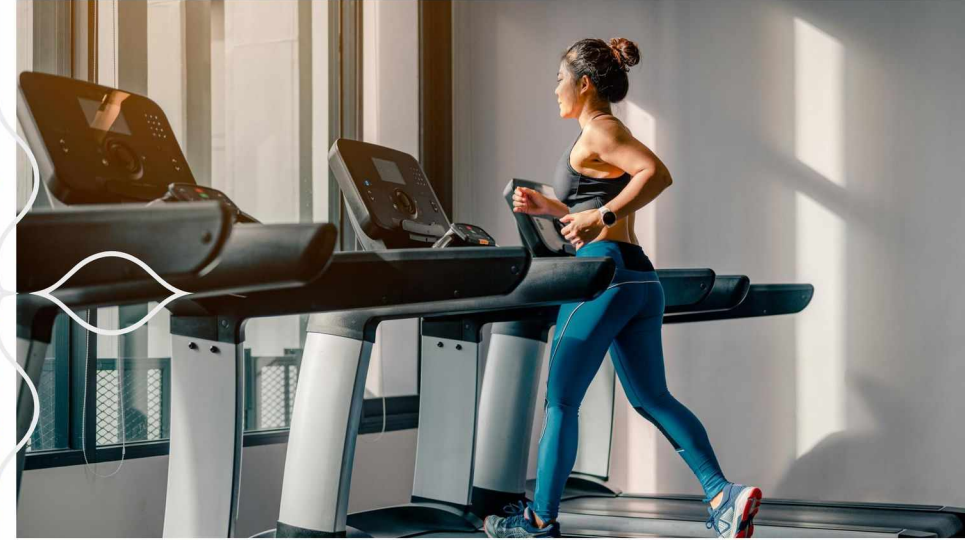

WELL EQUIPPED
MODERN
GYMNASIUM

In our state-of-the-art gym, where health meets elegance, elevate your exercise journey. Our fitness center reimagines the art of wellness to serve the discerning resident. It provides a sanctuary where you may reach peak physical well-being, shape your body, and revive your spirit thanks to its cutting-edge technology.





TABLE TENNIS



BILLIARD TABLE

SERVE, SPIN, AND UNWIND

Whether you seek a friendly match with friends or wish to practice your skills in solitude, our meticulously designed table tennis area awaits. Featuring top-of-the-line equipment, it provides the perfect setting for exhilarating games and memorable moments.



WHERE LUXURY MEETS LEISURE

Our expertly crafted pool table game area exemplifies the marriage of luxury and fun. It invites you to engage in passionate matches or unwind in elegance with friends and family, all while maintaining an unshakable dedication to refinement.

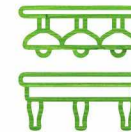

SPECIFICATIONS



STRUCTURE

- Energy-Efficient & Eco-Friendly Design
- Earthquake-Resistant RCC Framed Structure
- Emergency Exit Provision through an Extra Staircase

APARTMENTS

- Premium Vitrified Tiles Flooring
- Premium Quality Paint on Walls & Ceilings
- Premium Quality Designer Laminated Flush Doors
- UPVC/Aluminum
- Windows

KITCHENS

- Stainless Steel Sink
- Granite Working Counters
- 2 Feet Tiles Dado above the Counter

WASHROOMS

- Grid False Ceiling
- Ceramic Tiles Flooring
- Premium Quality CP Fittings
- Premium Quality Sanitary Ware
- Floor-Mounted WC
- Designer Ceramic Wall Tiles up-to Door Height

ELECTRICAL

- Premium Quality Wires & Cables
- Premium Quality Modular Switches & Accessories

WATER SUPPLY

- Solid Waste Disposal Plant
- 24 X 7 Water Supply through Overhead Tank
- Underground Water Tank for Additional Storage
- Rainwater Harvesting System to Recharge Ground water

SECURITY SYSTEM

- Round the Clock 3 Tier Security
- 24 X 7 CCTV Surveillance System

COMMON AMENITIES

- High-Speed Elevators
- Designer Entrance Lobby
- Power Back-Up in each Flat
- Power Backup in Common Areas
- Separate Garden with Kids Play Area.
- Provision for EV Charging

- Main Entrance Gate with Separate Entry & Exit Driveways
- Indoor Games Room consisting of Pool, Table
- Tennis, Carrom & Chess Etc.
- Well-Equipped Clubhouse consisting of Swimming Pool, Gymnasium



ELEVATE YOUR EXPECTATIONS, WHERE EVERY DETAIL MATTERS



CENTURY 21
THE REAL ESTATE REVOLUTION

Century 21 is a well-known and respectable real estate company. Century 21 has a lot of experience in this field, and we know who is looking to buy a home. We are working for you as a real estate business with local knowledge, which offers you an advantage in finding and presenting your home. Century 21 thinks that a house is more than just four walls. It's an emotion, a life experience, and Century 21 always considers that.

ABOUT THE GROUP

Previous Projects



The Century Elite
Bhakraota, Jaipur



The Century One
Thikariya, Jaipur



Eco World
Jagdamba Nagar, Jaipur



Eco World 2
Jagdamba Nagar, Jaipur



Eco World 1
Mansarovar Extension, Jaipur

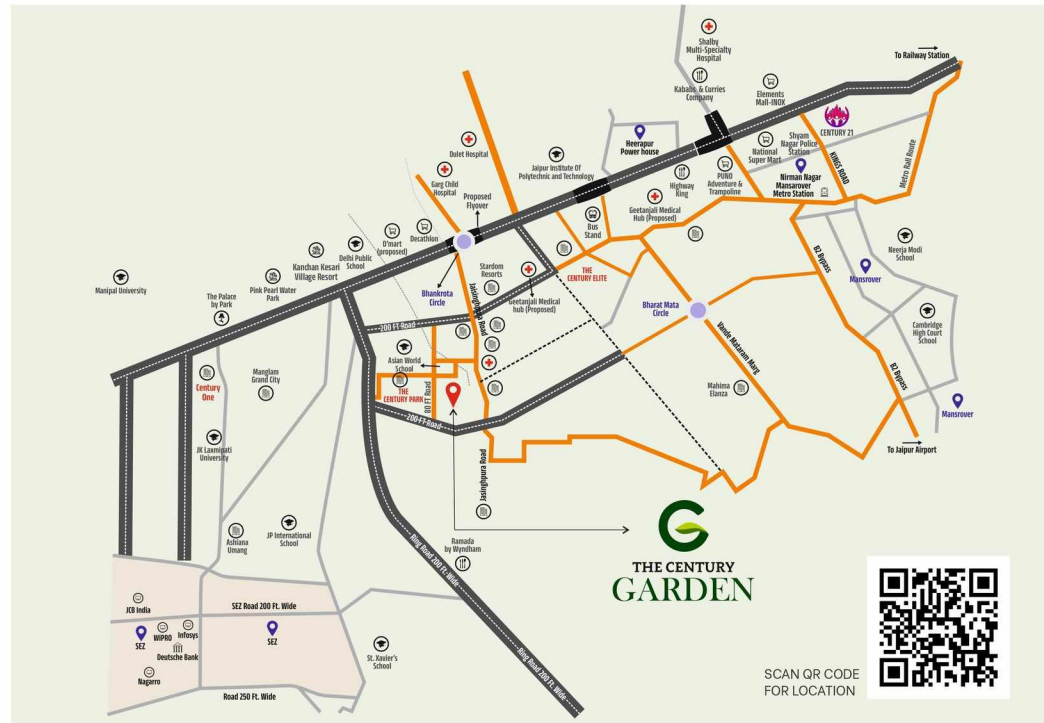

DISTANCE CHART

• Bus Stand 20 Min | • Railway Station 20 Min | • Vaishali 15 Min | • Mansarovar Metro Station

Education

- Asian World School 1 Min
- St. Xavier's 14 Min
- DPS 6 Min
- Jayshree Periwel 10 Min

Health

- Geetanjali Medical College & Hospital 7 Min
- Duleet Hospital 12 Min
- Garg Child Hospital 13 Min

Entertainment/Leisure Activities

- Pink Pearl Water Park 7 Min
- Kanchan Kesari 6 Min
- Decathlon Sport 10 Min
- Puno 17 Min
- Ramada 7 Min

Office & College

- Mahindra World Sez 15 Min
- Manipal University 22 Min
- J.K. Laxminipati University 14 Min
- Jaipur Institute Of Polytechnic and Technology 16 Min



Century 21 Builders And Promoters Pvt Ltd
1st Floor, Plot No 262, Nirman Nagar-C,
Opp.Shyam Nagar Thana, Kings Road Jaipur-302019

E-mail : info@century21jaipur.com
Website : www.century21jaipur.com

THE CENTURY GARDEN

Near Asian World School, Medical Hub, Mansarovar Ext,
Jaisinghpura Ajmer Road, Jaipur, Rajasthan 302026

Disclaimer: This Brochure is purely conceptual and not a legal offering. Further the Promoters/Architect reserve the right to add/delete/ modify any details/specifications/elevation mentioned